

CORNER RECORD

Document Number 07-0357

City of Murrieta County of Riverside, California

Brief Legal Description Clinton Keith Road & Rancho Mirlo Road

SEC. 12, T7S, R4W



CORNER TYPE

Government Corner Control
 Meander Property
 Rancho Other
 Date of Survey 2/5/07

COORDINATES (Optional)

N. _____
 E. _____
 Zone _____ NAD27 NAD83
 NAD83 Epoch _____
 Elevation _____
 Vertical Datum: NGVD29 NAVD88
 Units: Metric Imperial U.S. Survey

Corner — Left as found Found and tagged Established Reestablished Rebuilt

Identification and type of corner found; Evidence used to identify or procedure used to establish or reestablish the corner:
Found as described on the reverse of this sheet.

A description of the physical condition of the monument as found and as set or reset: _____

See Sheet 2

SURVEYOR'S STATEMENT

This Corner Record was prepared by me or under my direction in conformance with
 the Professional Land Surveyors' Act on March 5, 2007

Signed [Signature] P.L.S. or R.C.E. No. L.S. 5411

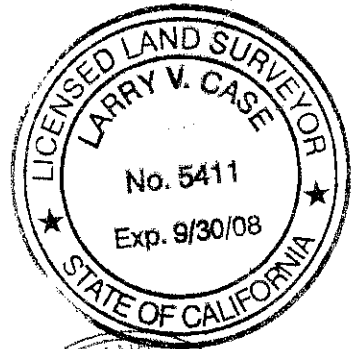

COUNTY SURVEYOR'S STATEMENT

This Corner Record was received 3/16/07

examined and filed 6/5/07

Signed [Signature] P.L.S. or R.C.E. No. 5705

Title Deputy County Surveyor



County Surveyor's Comment _____

R-1 = CO. OF RIVERSIDE TR 23879-1, MB 245/10-18

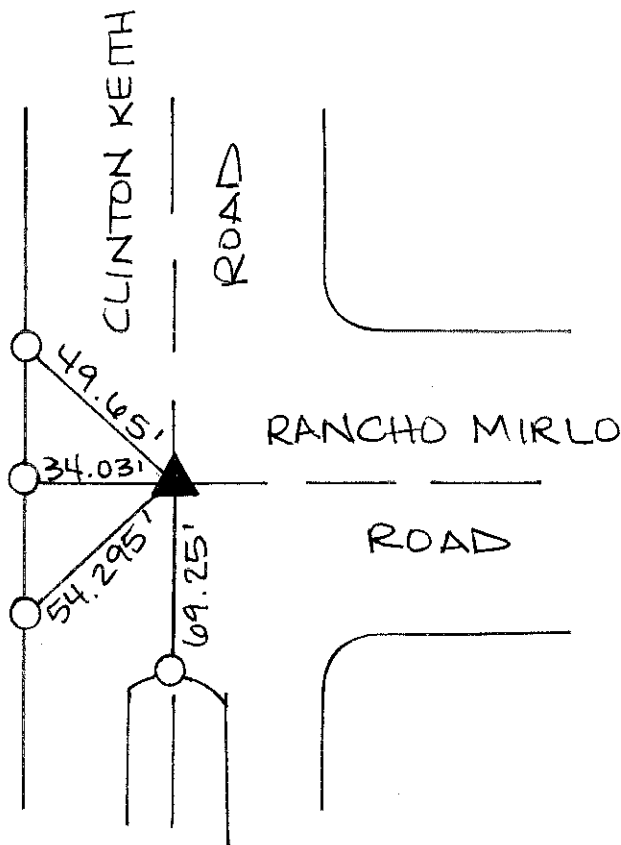

- ▲ FD. 1 1/4" I.P. w/ PUN. PLASTIC PLUG (NO #) FLUSH (ACCEPTED AS 1 1/4" I.P. TAGGED RCE 12614 AS SHOWN ON R-1). PRIOR TO CONSTR. SET SPR/W L.S. 5411 AFTER CONSTR.
- SET LIT & TAG L.S. 5411 IN T.C.

The purpose of this record is to document the perpetuation of found monument(s) pursuant to the PLS Act Section 8771. No claim is made regarding the correctness of the position(s) of said monument(s), nor the dimensional relationship to street centerlines or property boundaries.

06-ALL-552